

Data sheet



SWIVELS: DYDI

PART No.: 10855113

Vers. August 25

Technical Data:

Pressure	500 bar 50 Mpa 7300 psi
Temperature	120°C 248°F
RPM	2000 U/min
Body	stainless Steel
Inner part	stainless Steel
Seal	Hard metal
Connection	G 3/8" F - G 3/8" M
Bearing	2 x Radial ball bearing 1 x Axial ball bearing

Dimension:

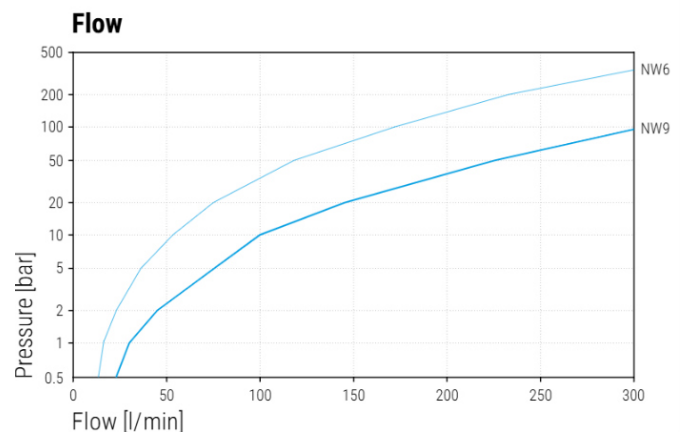
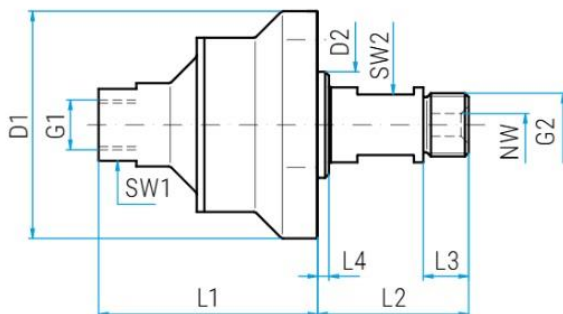

Part No.:	G1 (F)	G2 (M)	NW	SW1	SW2	L1	L2	L3	L4	D1	D2
10855113	G 3/8"	G 3/8"	6	22	16	58	37	12	3	60	28

Legend

M.. = metric thrust, **..M** = male, **F** = female, **G** = gas pipe thrust, **R** = gas pipe thrust conical, **QV** = quick connects
SV = profile ring fitting, **D** = diameter, **L** = length, **NW** = nominal width, **SW** = wrench size